

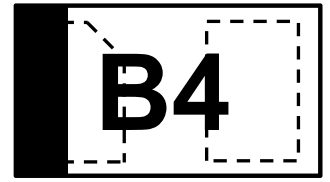

### Features

- Low forward Voltage
- Fast switching

DFN1x0.6-2L



Marking Code: B4

### Absolute Maximum Ratings ( $T_A=25^\circ\text{C}$ )

Parameter	Symbols	Value	Unit
Repetitive Peak Reverse Voltage	$V_{RRM}$	40	V
Average Rectified Forward Current	$I_{F(AV)}$	200	mA
Non-Repetitive Peak Forward Surge Current at 8.3ms	$I_{FSM}$	250	mA
Power Dissipation	$P_D$	120	mW
Thermal Resistance Junction to Ambient Air	$R_{\theta JA}$	833	$^\circ\text{C/W}$
Junction Temperature	$T_J$	125	$^\circ\text{C}$
Storage Temperature Range	$T_{STG}$	-55 to +125	$^\circ\text{C}$

### Electrical Characteristics ( $T_A=25^\circ\text{C}$ )

Parameter	Symbols	Min.	Max.	Unit
Forward Voltage at $I_F = 1 \text{ mA}$ at $I_F = 40 \text{ mA}$	$V_F$	--	0.38 1	V
Reverse Current at $V_R = 30 \text{ V}$	$I_R$	--	0.2	$\mu\text{A}$
Breakdown Voltage at $I_R = 10 \mu\text{A}$	$V_{R(BR)}$	40	--	V
Total Capacitance at $V_R = 0 \text{ V}$ , $f = 1 \text{ MHz}$	$C_T$	--	5	pF
Reverse Recovery Time at $I_F = I_R = 5 \text{ mA}$ , $I_{rr} = 0.1 \times I_R$ , $R_L = 100 \Omega$	$T_{rr}$	--	5	ns



### Typical Characteristic Curves

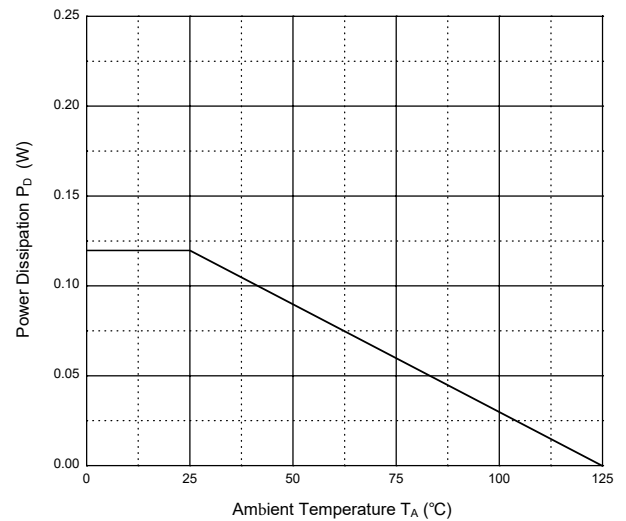
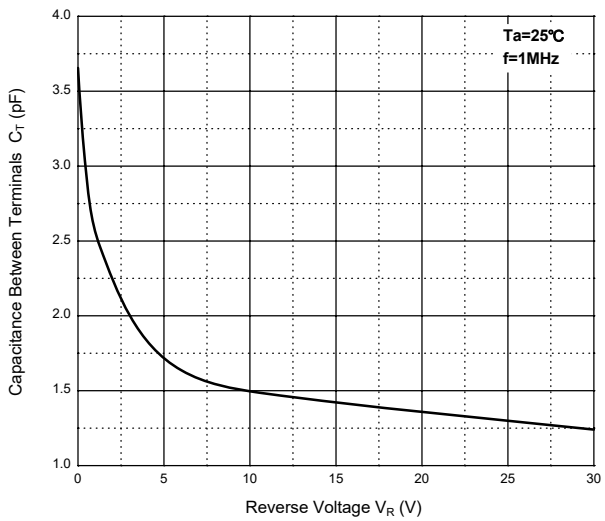
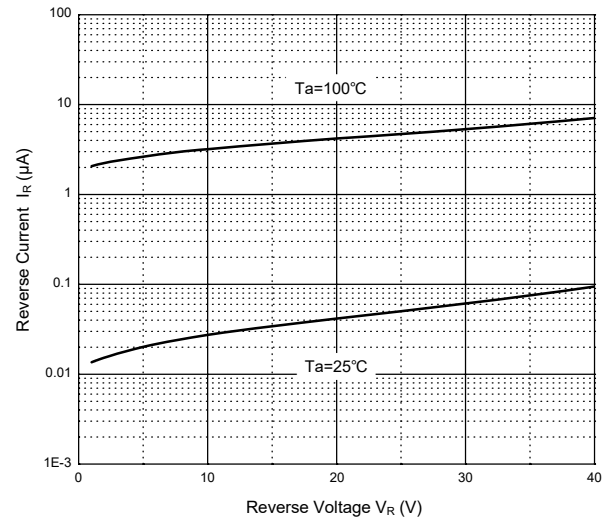
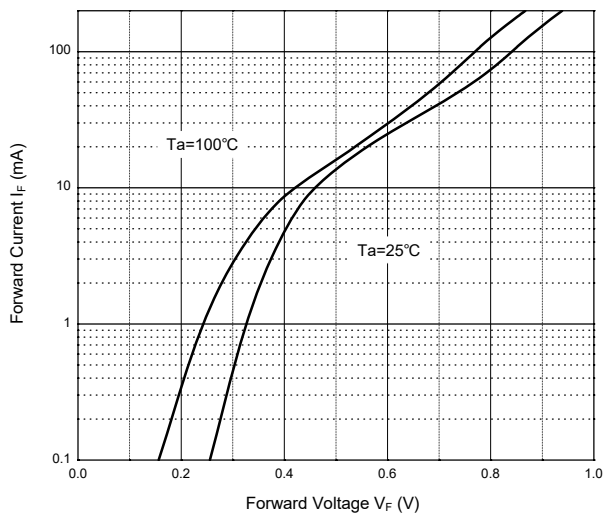



### Package Outline

DFN1x0.6-2L-0011

Dimensions in mm

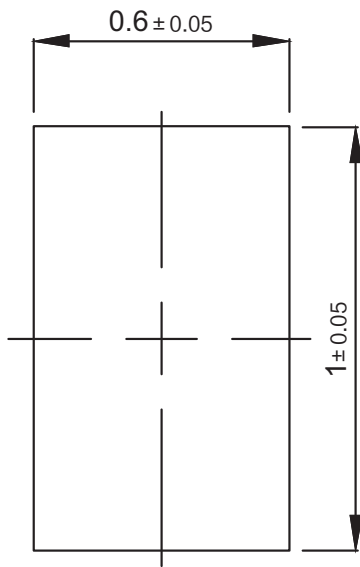

TOP VIEW

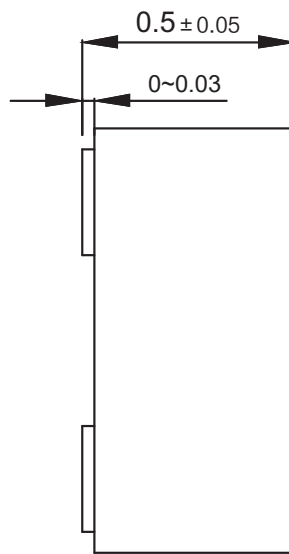

SIDE VIEW

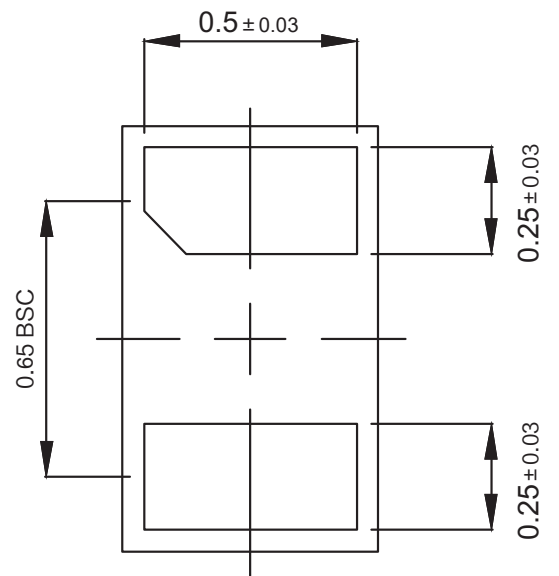

BOTTOM VIEW

### Ordering Information

Device	Package	Shipping
BAS40DB	DFN1x0.6-2L	10,000PCS/Reel&7inches