

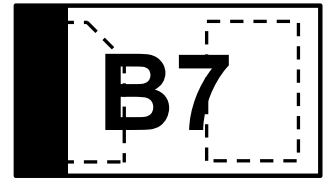

### Features

- Low forward Voltage
- Fast switching

DFN1x0.6-2L



Marking Code: B7

### Absolute Maximum Ratings ( $T_A=25^\circ\text{C}$ )

| Parameter  | Symbols         | Value       | Unit                      |
|--|-----------------|-------------|---------------------------|
| Maximum DC Blocking Voltage                        | $V_R$           | 70          | V                         |
| Forward Continuous Current                         | $I_F$           | 70          | mA                        |
| Non-Repetitive Peak Forward Surge Current at 8.3ms | $I_{FSM}$       | 100         | mA                        |
| Power Dissipation                                  | $P_D$           | 120         | mW                        |
| Thermal Resistance Junction to Ambient Air         | $R_{\theta JA}$ | 833         | $^\circ\text{C}/\text{W}$ |
| Junction Temperature                               | $T_J$           | 125         | $^\circ\text{C}$          |
| Storage Temperature Range                          | $T_{STG}$       | -55 to +125 | $^\circ\text{C}$          |

### Electrical Characteristics ( $T_A=25^\circ\text{C}$ )

| Parameter  | Symbols     | Min.     | Max.      | Unit          |
|--|-------------|----------|-----------|---------------|
| Forward Voltage<br>at $I_F = 1\text{ mA}$<br>at $I_F = 15\text{ mA}$   | $V_F$       | --<br>-- | 0.41<br>1 | V             |
| Reverse Current<br>at $V_R = 50\text{ V}$  | $I_R$       | --       | 0.1       | $\mu\text{A}$ |
| Breakdown Voltage<br>at $I_R = 10\text{ }\mu\text{A}$  | $V_{R(BR)}$ | 70       | --        | V             |
| Total Capacitance at<br>$V_R = 1\text{ V}$ , $f = 1\text{ MHz}$  | $C_T$       | --       | 2         | pF            |
| Reverse Recovery Time<br>at $I_F = I_R = 10\text{ mA}$ , $I_{rr} = 0.1 \times I_R$ , $R_L = 100\text{ }\Omega$ | $T_{rr}$    | --       | 5         | ns            |



### Typical Characteristic Curves

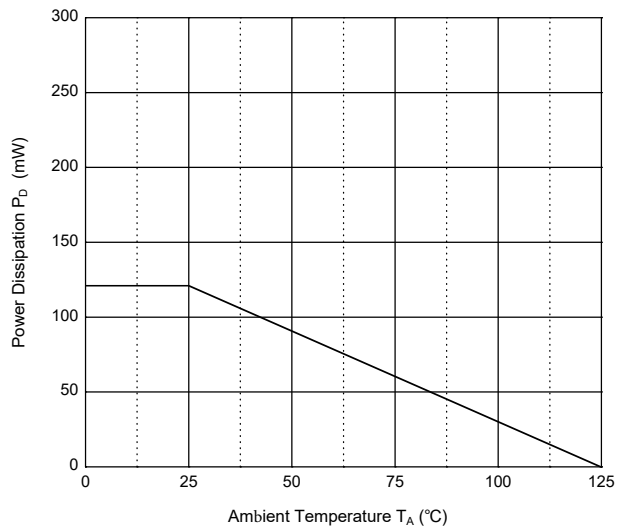
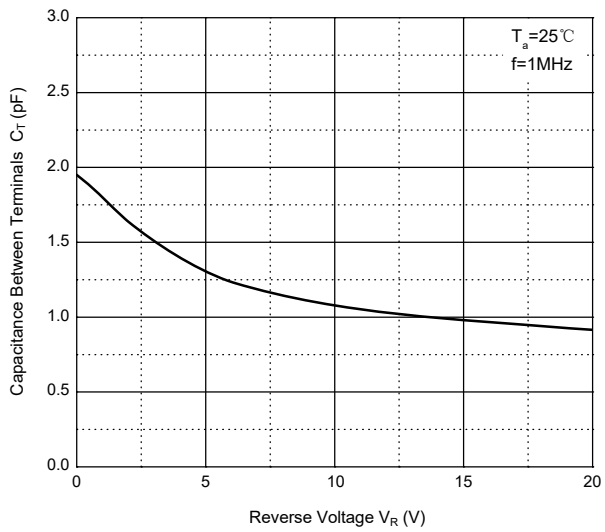
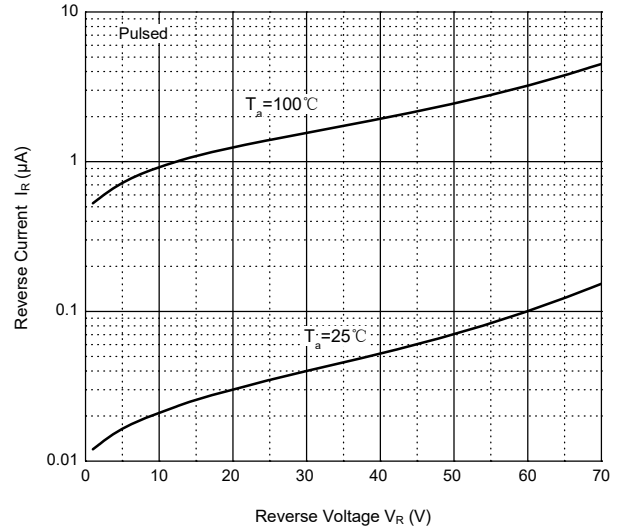
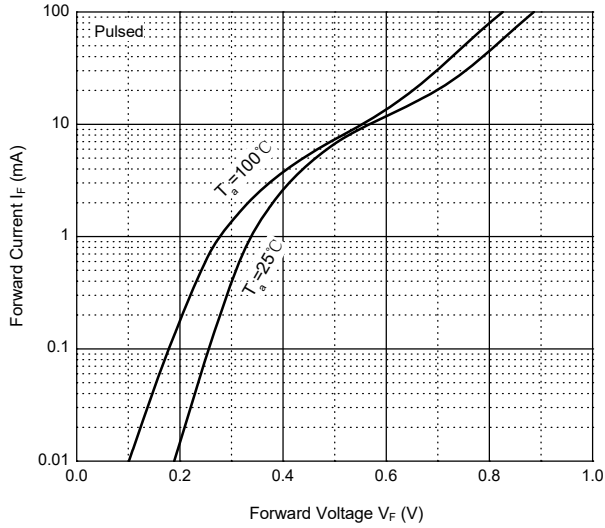



### Package Outline

DFN1x0.6-2L-0011

Dimensions in mm

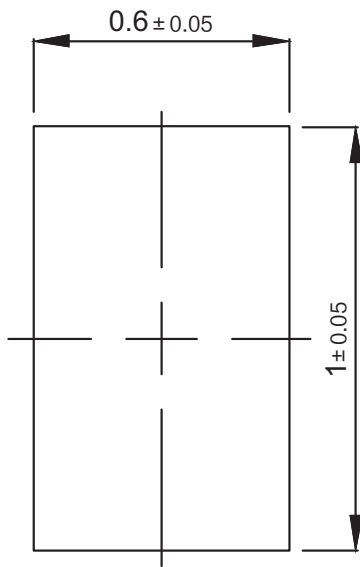

TOP VIEW

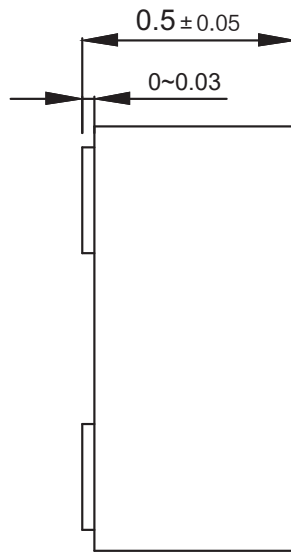

SIDE VIEW

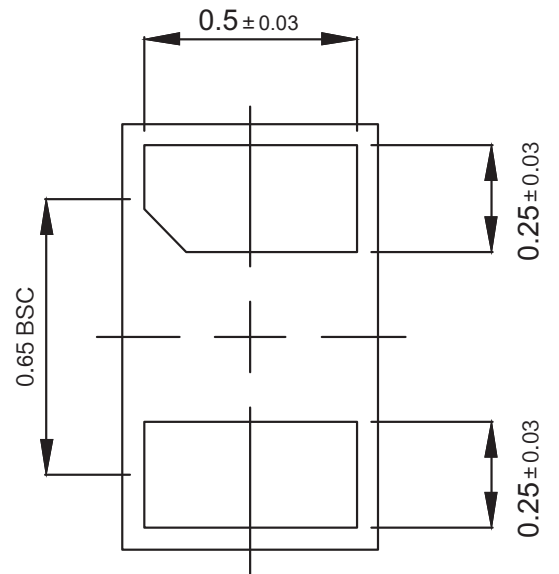

BOTTOM VIEW

### Ordering Information

| Device  | Package     | Shipping               |
|---------|-------------|------------------------|
| BAS70DB | DFN1x0.6-2L | 10,000PCS/Reel&7inches |